

# **HODAKA**

## **ACE 90**



# **Racing Parts**

Fig No.	Part No.	Part Name	Unit Q'ty.	Price
A- 1	912501R	Cylinder head .....	1pc.	
A- 2	902502	" " gasket .....	1 "	
A- 3	912505R	Cylinder .....	1 "	
A- 4	902506	" inlet stud .....	2 "	
A- 5	902509	Exhaust gasket .....	1 "	
A- 6	902507	Cylinder base gasket .....	1 "	
B- 1	912700R	Crank shaft ass'y (B-1-1~B-1-7) .....	1set	
B- 1-1	912701	" " (magneto side) .....	1pc.	
B- 1-2	912702	" " (output side) .....	1 "	
B- 1-3	912710R	Connecting rod .....	1 "	
B- 1-4	912712R	Needle roller bearing (small end) .....	1 "	
B- 1-5	902703	Crank pin .....	1 "	
B- 1-6	902709	Needle roller bearing (large end) .....	1 "	
B- 1-7	902705	Crank pin thrust washer .....	2 "	
B- 2	9101480R	Piston .....	1 "	
B- 2-1*	9101482R	" #20 (oversize) .....		
B- 2-2*	9101484R	" #40 (oversize) .....		
B- 3	9102480R	Piston ring .....	1 "	
B- 3-1*	9102482R	" " #20 (oversize) .....		
B- 3-2*	9102484R	" " #40 (oversize) .....		
B- 4	902707	Piston pin .....	1 "	
B- 5	902708	" " snap ring .....	2 "	
B- 6	904014	Crank shaft nut (left hand thread) .....	1 "	
B- 7	904013	" " lock washer .....	1 "	
B- 8	914000R	Clutch ass'y (B- 8-1~B- 8-12) .....	1set	
B- 8-1	914008	" cover .....	1pc.	
B- 8-2	914011	" spring .....	6 "	
B- 8-3	914012R	" hub .....	1 "	
B- 8-4	904015	" thrust washer outside .....	1 "	
B- 8-5	904006	" friction disc .....	4 "	
B- 8-6	564007	" plate .....	3 "	
B- 8-7	914004R	" cage .....	1 "	
B- 8-8	564005	" " cover .....	1 "	
B- 8-9	904009	" flat head screw .....	6 "	
B- 8-10	904010	" safety wire .....	1 "	
B- 8-11	914002R	" rotor gear .....	1 "	
B- 8-12	904017	" inner spring .....	6 "	
B- 9	914003R	" pinion gear (1.75M) .....	1 "	
B-10	90402505	Clutch disc spacer t=0.5mm .....	2 "	

\*optional

# A

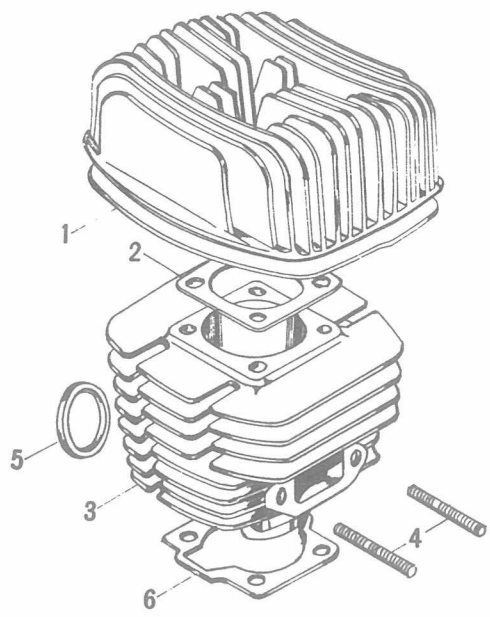

# B

1 (1-1~1-7)

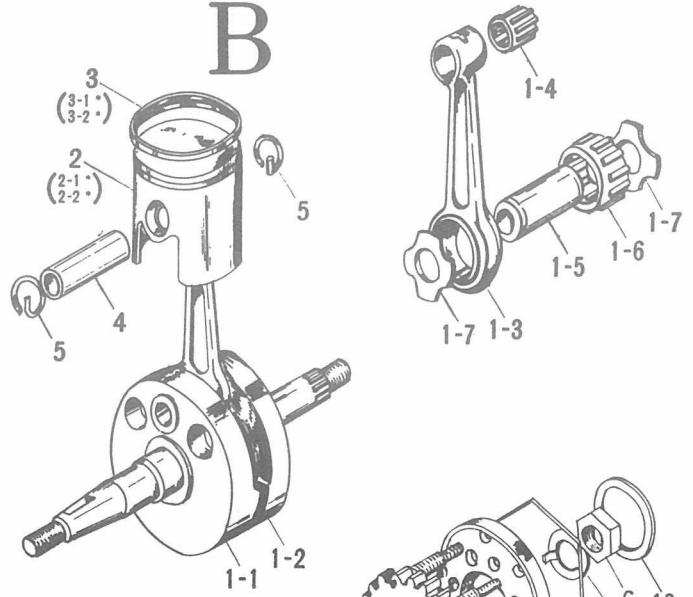

8 (8-1~8-12)

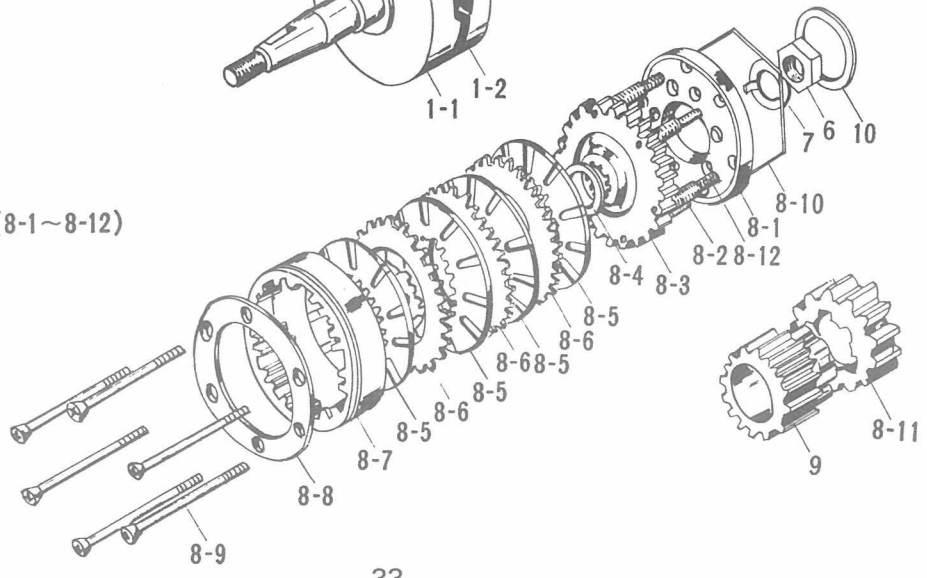

Fig No.	Part No.	Part Name	Unit Q'ty.	Price
C- 1	904501B	Main shaft .....	1pc.	
C- 2	914506R	Primary gear (1.75M) .....	1 "	
C- 3	(62)12026	Main shaft lock washer .....	1 "	
C- 4	(63)12024	" " spring washer .....	1 "	
C- 5	904503	" " nut .....	1 "	
D- 1	913000R	Stator ass'y (D- 2~D-15) .....	1set	
D- 2	(46)0512	" screw .....	2pc.	
D- 3	903008 ISO	" frame .....	1 "	
D- 4	903010	Condenser .....	1 "	
D- 5	903011	" screw .....	1 "	
D- 6	903016	Contact breaker (points) .....	1 "	
D- 7	903017	" " screw .....	1 "	
D- 8	(63)0401	" " spring washer .....	1 "	
D- 9	(62)04008	" " washer .....	1 "	
D-10	903023	Felt lubrication pad .....	1 "	
D-11	903024	" " " screw .....	1 "	
D-12	903020	Wire cord stopper .....	1 "	
D-13	903021	" " " screw .....	1 "	
D-14	913027R	Ignition wire cord .....	1 "	
D-15	913028R	" " " grommet .....	1 "	
D-16	913007R	Point cam .....	1 "	
D-17	913009R	Ignition coil .....	1 "	
D-18	913029R	" " bracket .....	1 "	
D-19	(10)0638	" " " bolt .....	2 "	
D-20	(61)06016	" " " washer .....	2 "	
D-21	(63)06015	" " " spring washer .....	4 "	
D-22	(52)06055	" " " nut .....	4 "	
D-23	918750R	Ignition switch .....	1 "	
E- 1	913600R	Air cleaner ass'y (E-2~E-10) .....	1set	
E- 2	913601R	" " cover .....	1pc.	
E- 3	913602R	" " element .....	1 "	
E- 4	913603R	" " joint .....	1 "	
E- 5	913604R	" " mount plate .....	1 "	
E- 6	913605R	" " element bolt .....	2 "	
E- 7	(61)06016	" " " washer .....	2 "	
E- 8	(63)06015	" " " spring washer .....	2 "	
E- 9	(51)06055	" " " nut .....	2 "	
E-10	913606R	Air cleaner rubber seal .....	1 "	
E-11	913607R	Air cleaner holder .....	1 "	
E-12	(10)08100	" " " bolt .....	1 "	
E-13	(61)08016	" " " washer .....	2 "	
E-14	(63)0802	" " " spring washer .....	1 "	
E-15	(51)0807	" " " nut .....	1 "	
E-16	913608R	" " rubber pad .....	1 "	
E-17	913609R	" " band .....	1 "	
E-18	913610R	" " band clip .....	2 "	

ISO standard screws are marked ( : ) on the screw head